

Colonial Brass Rim Locks

0

1

REVISION
APR 2005

TABLE OF CONTENTS

Specifications/Standards of Excellence	2
Specifications	3
Door Conditions	3
Lock Plates	3
Finishes	3
Vertical Rim Locks (5600 Series)	5
Horizontal Rim Locks (5700 Series)	6
Horizontal Rim Locks (5630/5640 Series)	7-10
Handle Set Rim Lock	11
Keyhole Door Latches	12
Components and Accessories	13-15
Full Dummy Trim and Lock Plates	15

Standards of Excellence

Pride in our American Heritage and renewed interest in the early history of our country has greatly influenced United States architecture. This is reflected in the large number of residences and public buildings constructed in the Neo-classic, Georgian or Palladian styles, which were forms most admired in the 18th century.

Since 1948, Baldwin Hardware Corporation has been committed to preserving our heritage by authentically reproducing a complete range of Rim Locks and other solid brass hardware appointments to accurately recreate the colonial brasses of America.

The entire product group depicted in this catalog section has been carefully researched and designed from original period artifacts. Modern technology has been incorporated to adapt these antique lock forms into functional security devices. The precise, forged brass construction of all internal working parts affords extreme durability and lasting performance. Every Baldwin product is finished to an unparalleled standard of excellence.

- Solid forged brass construction for maximum strength and durability. (Hot forged products have 250% greater tensile strength over castings.)
- Rim locks are offered in both PVD lifetime (003) and unlaquered brass (031) finishes.
- Trim designs are secured to a broached spindle with an epoxy (resin) coated set screw to prohibit screw from loosening.
- All rim locks are constructed with solid forged brass parts for exceptional durability and smooth, lifetime operation.
- Interior rim locks use bit keys. Bit keys may be ordered fixed permanently into the lock by ordering as .RBIT or .LBIT configurations.
- Our Design Department works closely with a number of America's most prestigious museums and historical foundations. Baldwin is renowned for meeting the stringent demands for quality and authenticity in the restoration-retrofit-rehabilitation markets.
- Numerous patents, copyrights, and trademarks are held by the Corporation to protect the integrity and reputation of our distinctive line of hardware appointments.

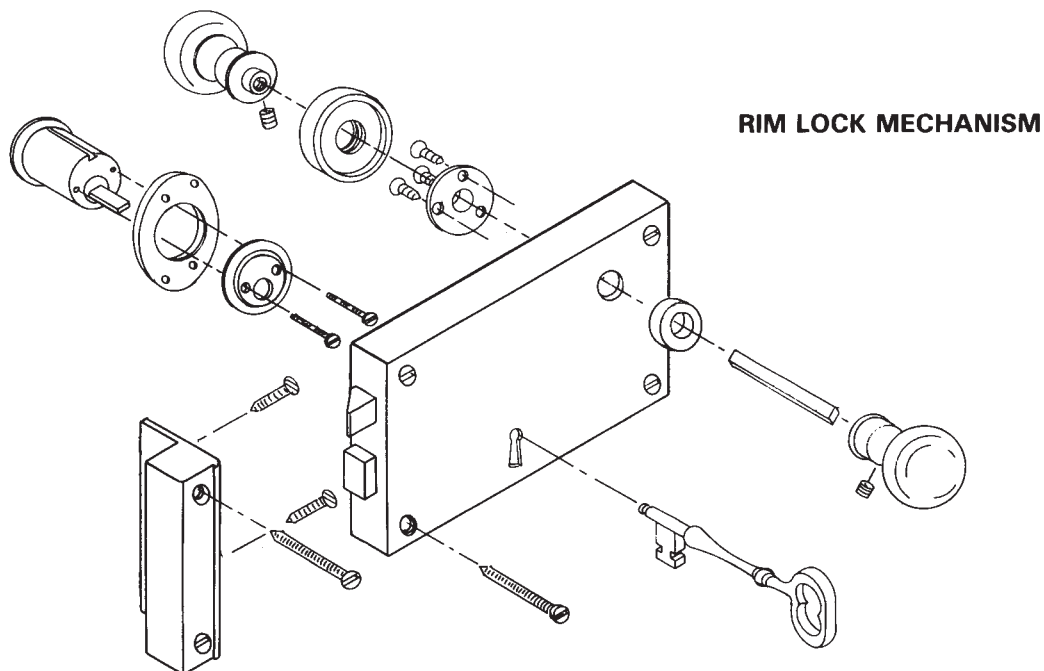

Rim Locks—Specifications

0
3
REVISION
APR 2005

HANDING OF RIM LOCKS

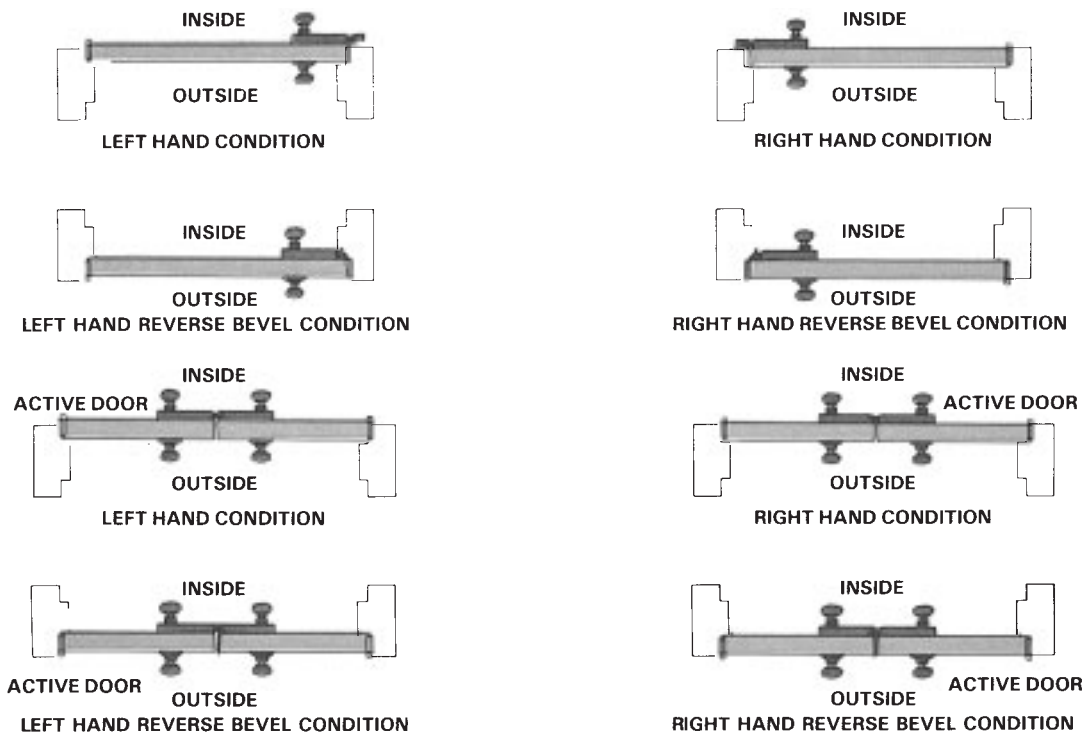

NOTE: THE HAND OF DOOR IS ALWAYS DETERMINED FROM THE OUTSIDE.

IMPORTANT: A dummy trim rim lock must be used on **ALL** pairs of reverse bevel doors. For additional information, refer to page O/13.

HANDING OF RIM LOCK PLATES



NOTE: LOCK PLATES ARE ONLY AVAILABLE FOR RIGHT AND LEFT HAND CYLINDER OPERATED RIM LOCKS; designed for use on the exterior side of the door. For further information, refer to page O/13.

FINISHES OF RIM LOCKS

Rim locks illustrated throughout this catalog section are available in appropriate finishes to authentically reflect the original appearance of the product: Please refer to price list for finish availability.

Forged Brass Rim Locks

FORGED BRASS VERTICAL RIM LATCH



No. 5600
Right Hand Shown

OPERATION: Latch bolt by knob either side.

SIZE: Case: 4.75" × 3.75" × .875" (121 × 95 × 22mm).

Keeper: 4.75" × .875" × 1.625" (121 × 22 × 41mm).

BACKSET: Front to knob hub: 2.75" (70mm).
Front to bit key: 2.75" (70mm).

TRIM: Included with lock: non-operable kit key No. 5755 which can be permanently fitted at extra charge. Working trim consists of pair of knobs No. 5030 and half pair of roses No. 5002.

FEATURES: These latches are designed for use primarily on interior doors. The narrow upright design is especially well suited for installation on narrow stile doors. Construction is solid brass.

PACKED: One in a box with necessary fasteners and template.

WEIGHT: 3.7 lbs. (1.68kg)

FORGED BRASS VERTICAL BIT KEY LOCK



No. 5602
Right Hand Shown

OPERATION: Latch bolt by knob either side. Dead bolt by bit key either side.

SIZE: Case: 4.75" × 3.75" × .875" (121 × 95 × 22mm).

Keeper: 4.75" × .875" × 1.625" (121 × 22 × 41mm).

BACKSET: Front to knob hub: 2.75" (70mm).
Front to bit key: 2.75" (70mm).

TRIM: Included with lock: bit key No. 5755 and cover plate No. 0406. Working trim consists of pair of knobs No. 5030 and half pair of roses No. 5002.

FEATURES: These locks are designed for use primarily on interior doors. Bit key is used with privacy function and can be permanently fitted at extra charge. Remaining features basically same as No. 5600.

PACKED: One in a box with necessary fasteners and template.

WEIGHT: 4 lbs. (1.81kg)

FORGED BRASS VERTICAL CYLINDER LOCK



No. 5604*
Right Hand Shown

OPERATION: Latch bolt by knob either side. Dead bolt by key outside and by slide bolt inside.

SIZE: Case: 4.75" × 3.75" × .875" (121 × 95 × 22mm).

Keeper: 4.75" × .875" × 1.625" (121 × 22 × 41mm).

BACKSET: Front to knob hub: 2.75" (70mm).
Front to centerline of cylinder: 2.75" (70mm).

TRIM: Included with lock: cylinder No. 8333 and cylinder cover plate No. 6755. Working trim consists of pair of knobs No. 5030 and half pair of roses No. 5002.

FEATURES: These locks are designed for use primarily on entrance doors. The entrance (cylinder) function, an exclusive feature of our rim locks, permits use of same size locks throughout the construction.

***NOTE:** Bit key function is not available with this lock.

PACKED: One in a box with necessary fasteners and template.

WEIGHT: 4.6 lbs. (2.09kg)

LOCKS SHOWN ON THIS PAGE ARE NOT REVERSIBLE. WHEN ORDERING ALWAYS SPECIFY HAND OF DOORS. FOR ADDITIONAL DETAILS SEE PAGE O/3.

IMPORTANT: A dummy trim rim lock must be used on **ALL** pairs of reverse bevel doors. For additional information, refer to page O/13.

Forged Brass Rim Locks

0

5

REVISION
APR 2005

FORGED BRASS HORIZONTAL RIM LATCH

OPERATION: Latch bolt by knob either side.

SIZE: Case: 3.75" × 4.75" × .875" (95 × 121 × 22mm).

Keeper: 3.75" × .875" × 1.625" (95 × 22 × 41mm).

BACKSET: Front to knob hub: 3.5" (89mm).

Front to bit key: 2.375" (60mm).

TRIM: Included with latch: non-operable bit key No 5755 which can be permanently fitted at extra charge. Working trim consists of pair of knobs No. 5030 and half pair of roses No. 5002.

FEATURES: These latches are designed for use primarily on interior doors.

PACKED: One in a box with necessary fasteners and template.

WEIGHT: 3.8 lbs. (1.72kg)

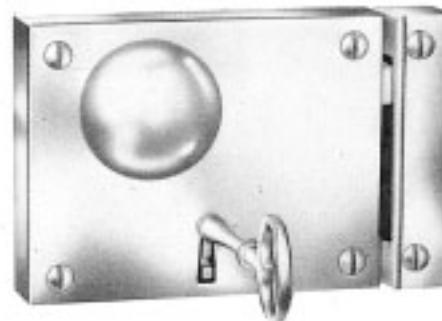

No. 5701

Right Hand Shown

FORGED BRASS HORIZONTAL BIT KEY PRIVACY LOCK

OPERATION: Latch bolt by knob either side. Dead bolt by bit key and slide bolt inside, emergency key outside.

SIZE: Case: 3.75" × 4.75" × .875" (95 × 121 × 22mm).

Keeper: 3.75" × .875" × 1.625" (95 × 22 × 41mm).

BACKSET: Front to knob hub: 3.5" (89mm).

Front to bit key: 2.375" (60mm). Front to emergency key: 3.5" (89mm).

TRIM: Included with lock: bit key No. 5755, cover plate No. 0406 and emergency key No. 5753, which should be stored in a readily accessible place, preferably on the door frame. Working trim consists of pair of knobs No. 5030 and half pair of roses No. 5002.

FEATURES: These locks are designed for use primarily on interior doors. Bit key is used for privacy and can be permanently fitted at extra charge. Basically same as lock No. 5701.

PACKED: One in a box with necessary fasteners and template.

WEIGHT: 4.2 lbs. (1.91kg)

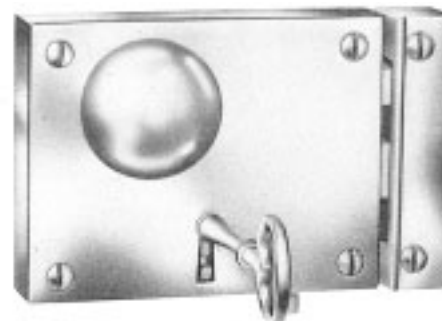

No. 5702

Right Hand Shown

FORGED BRASS HORIZONTAL CYLINDER LOCK

OPERATION: Latch bolt by knob either side. Dead bolt by cylinder key outside and slide bolt or bit key inside.

SIZE: Case: 3.75" × 4.75" × .875" (95 × 121 × 22mm).

Keeper: 3.75" × .875" × 1.625" (95 × 22 × 41mm).

BACKSET: Front to knob hub: 3.5" (89mm). Front to bit key: 2.375" (60mm). Front to centerline of cylinder: 3.5" (89mm).

TRIM: Included with lock: cylinder No. 8333, cylinder collar No. 6757, and bit key No. 5755 which can be permanently fitted at extra charge. Working trim consists of pair of knobs No. 5030 and half pair of roses No. 5002.

FEATURES: These locks are designed for use primarily on entrance doors. No. 5704 is made of solid brass. The entrance (cylinder) function, an exclusive feature of our rim locks, permits use of same size locks throughout the construction.

PACKED: One in a box with necessary fasteners and template.

WEIGHT: 4.6 lbs. (2.09kg)

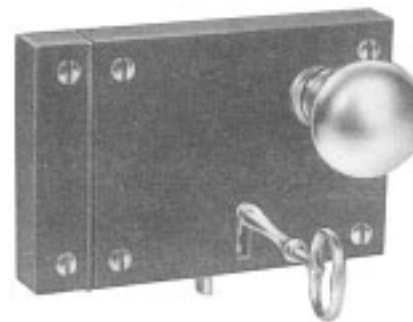

No. 5704

Left Hand Shown

LOCKS SHOWN ON THIS PAGE ARE NOT REVERSIBLE. WHEN ORDERING ALWAYS SPECIFY HAND OF DOORS. FOR ADDITIONAL DETAILS SEE PAGE O/3.

IMPORTANT: A dummy trim rim lock must be used on **ALL** pairs of reverse bevel doors. For additional information, refer to page O/13.

Forged Brass Rim Locks

FORGED BRASS HORIZONTAL RIM LATCH



No. 5630
Left Hand Shown

OPERATION: Latch bolt by knob either side.

SIZE: Case: 4" × 6.75" × .875" (102 × 171 × 22mm).

Keeper: 4" × .875" × 1.625" (102 × 22 × 41mm).

BACKSET: Front to knob hub: 5.25" (133mm)

TRIM: Included with latch: non-operable bit key No. 5755 which can be permanently fitted at extra charge. Working trim consists of pair of knobs No. 5030 and half pair of roses No. 5002.

FEATURES: These latches are designed for use primarily on interior doors.

PACKED: One in a box with necessary fasteners and template.

WEIGHT: 4.4 lbs. (2kg)

FORGED BRASS HORIZONTAL BIT KEY RIM LOCK



No. 5632
Left Hand Shown

OPERATION: Latch bolt by knob either side.

Dead bolt by bit key either side.

SIZE: Case: 4" × 6.75" × .875" (102 × 171 × 22mm).

Keeper: 4" × .875" × 1.625" (102 × 22 × 41mm).

BACKSET: Front to knob hub: 5.25" (133mm).

Front to bit key: 4" (102mm).

TRIM: Included with lock: bit key No. 5755 and cover plate No. 0406. Working trim consists of pair of knobs No. 5030 and half pair of roses No. 5002.

FEATURES: These locks are designed for use primarily on interior doors. Bit key is used for privacy and can be permanently fitted at extra charge. Basically same lock as No. 5630.

PACKED: One in a box with necessary fasteners and template.

WEIGHT: 4.8 lbs. (2.18kg)

FORGED BRASS HORIZONTAL CYLINDER LOCK



No. 5634
Left Hand Shown

OPERATION: Latch bolt by knob either side. Dead bolt by cylinder key outside and by slide bolt and bit key inside.

SIZE: Case: 4" × 6.75" × .875" (102 × 171 × 22).

Keeper 4" × .875" × 1.625" (102 × 22 × 41mm).

BACKSET: Front to knob hub: 5.25" (133mm). Front to bit key: 4" (102mm). Front to centerline of cylinder: 3" (76mm).

TRIM: Included with lock: cylinder No. 8333, cylinder cover plate No. 6755 and bit key No. 5755 which can be permanently fitted at extra charge. Working trim consists of pair of knobs No. 5030 and half pair of roses No. 5002.

FEATURES: Most popular size rim lock in our line, designed for use primarily on entrance doors. The entrance (cylinder) function, an exclusive feature of our rim locks, permits use of same size locks throughout the construction.

PACKED: One in a box with necessary fasteners and template.

WEIGHT: 5.5 lbs. (2.50kg)

LOCKS SHOWN ON THIS PAGE ARE NOT REVERSIBLE. WHEN ORDERING ALWAYS SPECIFY HAND OF DOORS. FOR ADDITIONAL DETAILS SEE PAGE O/3.

IMPORTANT: A dummy trim rim lock must be used on **ALL** pairs of reverse bevel doors. For additional information, refer to page O/13.

Forged Brass Rim Locks

0
7
REVISION
APR 2005

FORGED BRASS BEVEL DESIGN RIM LOCK

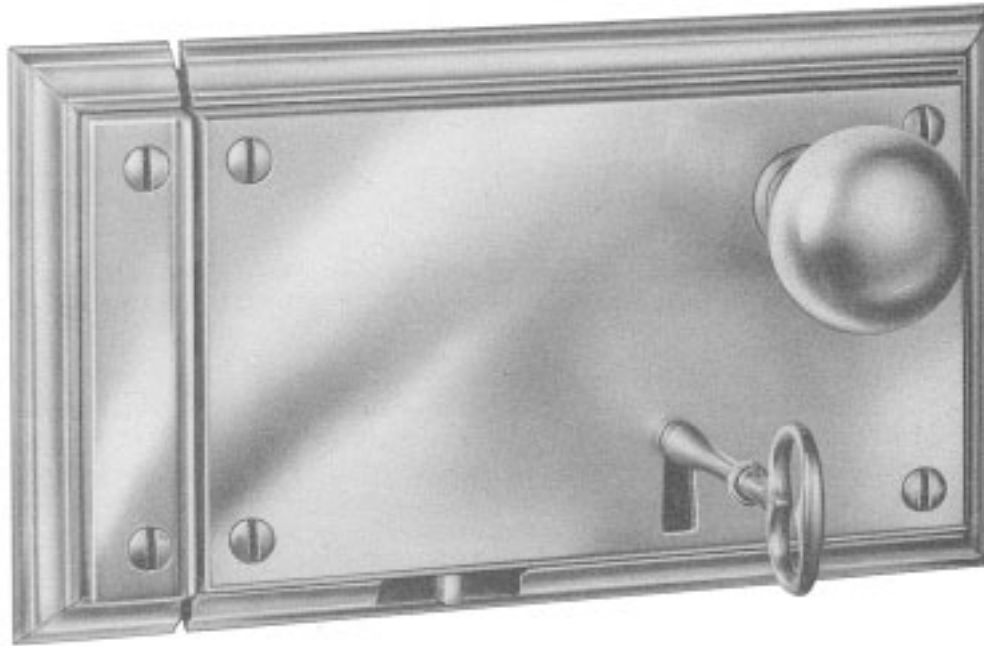

No. 5636
Left Hand Shown

OPERATION: Latch bolt by knob either side. Dead bolt by cylinder key outside and by slide bolt and bit key inside.

SIZE: Case: 5" × 7.25" × .875" (127 × 184 × 22mm). Keeper: 5" × 1.375" × 1.625" (127 × 35 × 41mm).

BACKSET: Front to knob hub: 5.25" (133mm). Front to bit key: 4" (102mm). Front to centerline of cylinder: 3" (76mm).

TRIM: Included with lock: cylinder No. 8333, cylinder cover plate No. 6755 and bit key No. 5755 which can be permanently fitted at extra charge. Working trim consists of pair of knobs No. 5030 and half pair of roses No. 5002

FEATURES: Authentically reproduced traditional design has gracious appearance. These locks are designed for use primarily on entrance doors. Made of solid forged brass.

PACKED: One in a box with necessary fasteners and template.

WEIGHT: 7.2 lbs. (3.27kg)

LOCKS SHOWN ON THIS PAGE ARE NOT REVERSIBLE. WHEN ORDERING ALWAYS SPECIFY HAND OF DOORS. FOR ADDITIONAL DETAILS SEE PAGE O/3.

IMPORTANT: A dummy trim rim lock must be used on **ALL** pairs of reverse bevel doors. For additional information, refer to page O/13.

0

8

REVISION
APR 2005

Forged Brass Rim Locks

FORGED BRASS BEVEL DESIGN RIM LOCK

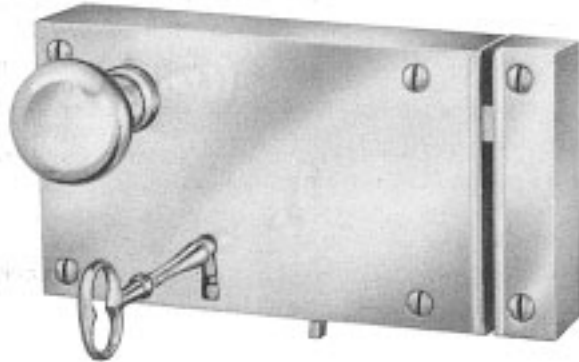

INSIDE

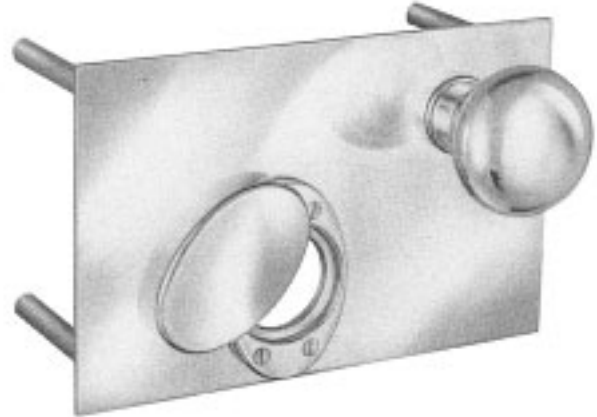

OUTSIDE

No. 5639

Left Hand Shown

NOTE: AVAILABLE FOR RIGHT AND LEFT HAND DOORS ONLY.

OPERATION: Latch bolt by knob either side. Dead bolt by cylinder key outside and by slide bolt and bit key inside.

SIZE: Case: 4" x 6.75" x .875" (102 x 171 x 22mm). Keeper: 4" x .875" x 1.625" (102 x 22 x 41mm).
Lock plate: 4" x 6.25" (102 x 159mm).

BACKSET: Front to knob hub: 5.25" (133mm). Front to bit key: 4" (102mm). Front to centerline of cylinder: 3" (76mm).

TRIM: Included with lock: cylinder No. 8333, cylinder cover plate No. 6755, bit key No. 5755, filler plate No. 0579 and lock plate No. 5629. Working trim consists of pair of knobs No. 5030.

FEATURES: Most popular size rim lock in our line, designed with specially fabricated lock plate for use primarily on metal clad door. Available for 1.75" (44mm) thick door ONLY.

PACKED: One in a box with necessary fasteners and template.

WEIGHT: 6.5 lbs. (2.95kg)

LOCKS SHOWN ON THIS PAGE ARE NOT REVERSIBLE. WHEN ORDERING ALWAYS SPECIFY HAND OF DOORS. FOR ADDITIONAL DETAILS SEE PAGE O/3.

IMPORTANT: A dummy trim rim lock must be used on ALL pairs of reverse bevel doors. For additional information, refer to page O/13.

Forged Brass Rim Locks

0

9

REVISION
APR 2005

FORGED BRASS HORIZONTAL CYLINDER LOCK

OPERATION: Latch bolt by knob either side. Dead bolt by cylinder key outside and slide bolt and bit key inside.

SIZE: Case: 5.75" × 10" × .875" (146 × 254 × 22mm).
Keeper: 5.75" × .875" × 1.625" (146 × 22 × 41mm).

BACKSET: Front to knob hub: 8" (203mm). Front to bit key: 6" (152mm). Front to centerline of cylinder: 5" (127mm).

TRIM: Included with lock: cylinder No. 8333, cylinder cover plate No. 6755 and bit key No. 5755 which can be permanently fitted at extra charge. Working trim consists of pair of knobs No. 5030 and half pair of roses No. 5002.

FEATURES: This rim lock is designed for use primarily on entrance doors.

PACKED: One in a box with necessary fasteners and template.

WEIGHT: 7.9 lbs. (3.58kg)

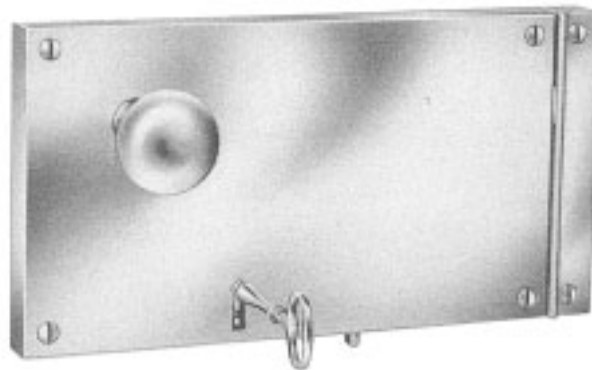

No. 5644

Right Hand Shown

RESERVED FOR
FUTURE ADDITIONS

LOCKS SHOWN ON THIS PAGE ARE NOT REVERSIBLE. WHEN ORDERING ALWAYS SPECIFY HAND OF DOORS. FOR ADDITIONAL DETAILS SEE PAGE O/3.

IMPORTANT: A dummy trim rim lock must be used on ALL pairs of reverse bevel doors. For additional information, refer to page O/13.

Forged Brass Handle Sets

ENTRANCE DOOR RIM LOCK

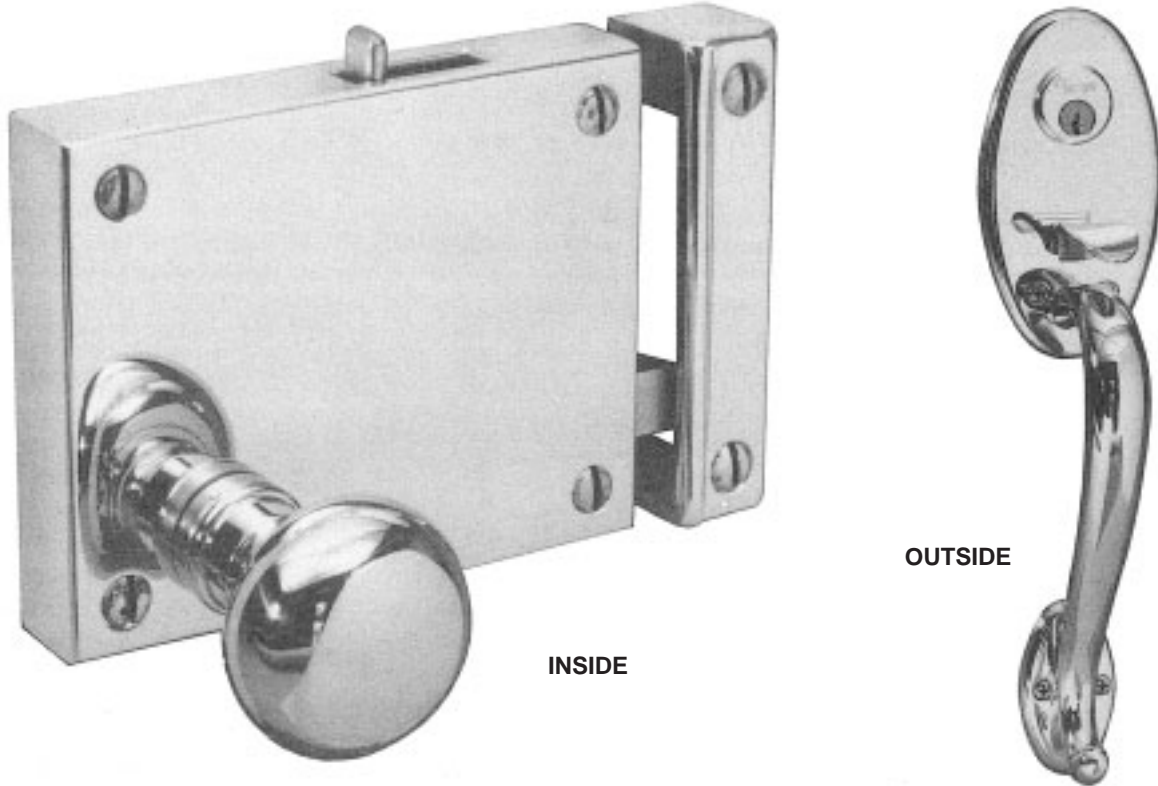

INSIDE

OUTSIDE

No. 5720
Right Hand Shown

OUTSIDE TRIM ONLY: No. 5722
INSIDE TRIM ONLY: No. 5723

KNOB: No. 5030
RIM CYLINDER: No. 8333

OPERATION: From Outside: Latch bolt by thumb piece, dead bolt by cylinder key. When bolted with cylinder key, thumb piece is rigid. From Inside: Latch bolt by knob dead bolt by slide bolt. When bolted with slide bolt, knob is rigid.

SIZE: Pull Handle: 3.25" × 13" × 6.5" (83 × 330 × 165mm) center to center. **Thumb piece will operate in doors from 1.75" to 2.0" (44 to 57mm) thick.** Rim Lock Case: 3.75" × 4.75" × .875" (95 × 121 × 22mm). Keeper: 3.75" × .875" × 1.625" (95 × 22 × 41mm).

BACKSET: Front to knob hub: 3.5" (89mm). Front to centerline of cylinder: 2.75" (70mm).

TRIM: Included with lock as illustrated.

FEATURES: Unusual combination of Early American rim lock on the inside of door with classic colonial "Pitcher Handle" sectional trim on the outside. Thumb piece operates latch and can be locked by turning cylinder key from outside or sliding dead bolt from inside.

PACKED: One in a box with necessary fasteners and template.

WEIGHT: 7.8 lbs. (3.54kg)

LOCKS SHOWN ON THIS PAGE ARE NOT REVERSIBLE. WHEN ORDERING ALWAYS SPECIFY HAND OF DOORS. FOR ADDITIONAL DETAILS SEE PAGE O/3.

IMPORTANT: A dummy trim rim lock must be used on **ALL** pairs of reverse bevel doors. For additional information, refer to page O/13.

Rim Lock Accessories

O

11

REVISION
APR 2005

EMERGENCY RELEASE KEY



No. 5753

SIZE: 4" (102mm) long.

FEATURES: Designed for use with our Privacy Rim and Mortise Lock.

BIT KEY – SOLID BRASS



No. 5755

SIZE: 4" (102mm) long.

FEATURES: Fits all our rim locks. Can be permanently fitted with locks to prevent unauthorized removal.

KEY PLATE – SOLID BRASS



No. 5754

SIZE: 2" × 1.125" (51 × 29mm).

CYLINDER COVER PLATE FORGED BRASS



No. 6755

SIZE: 2.375" × 1.625" (60 × 41mm)

FEATURES: For use with all standard rim lock cylinders (except 5704 Rim Lock).

KEY PLATE COVER FORGED BRASS



No. 0406

SIZE: 2.312" × .687" (59 × 17mm).

SOLID BRASS SPACER

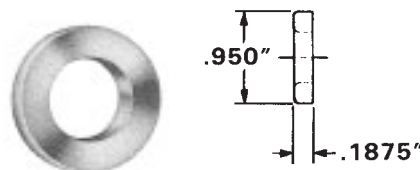

No. 5758

FEATURES: Spacer designed for use with knob trim during installation on rim lock case. Furnished standard with all rim lock sets.

Rim Lock Trim

RIM LOCK KEEPERS – SOLID BRASS

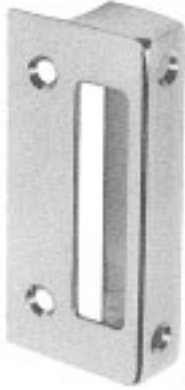

No. 5601 No. 5631
No. 5641 No. 5671

Item No.	Size			Will Fit Rim Locks
	A	B	C	
5601	4.75" (121mm)	.875" (22mm)	1.625" (41mm)	5600, 5602, 5604
5631	4" (102mm)	.875" (22mm)	1.625" (41mm)	5630, 5632, 5634, 5639
5641	5.75" (146mm)	.875" (22mm)	1.625" (41mm)	5644
5671	3.75" (95mm)	.875" (22mm)	1.625" (41mm)	5701, 5702, 5704, 5720

REVERSE BEVEL STRIKES FOR RIM LOCKS – SOLID BRASS

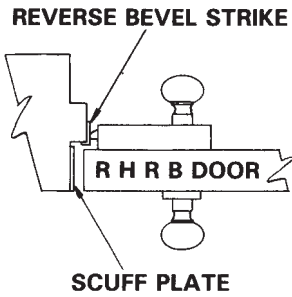

No. 5603 No. 5628
No. 5642 No. 5672

Item No.	Size	Will Fit Rim Locks
5603	4.75" x 1" x .375" (121 x 25 x 10mm)	5600, 5602, 5604
5628	4" x 1" x .375" (102 x 25 x 10mm)	5630, 5632, 5634, 5639
5642	5.75" x 1" x .375" (146 x 25 x 10mm)	5644
5672	3.75" x 1" x .375" (95 x 25 x 10mm)	5701, 5702, 5704, 5720

IMPORTANT: A dummy trim rim lock must be used on **ALL** pairs of reverse bevel doors. For additional information, refer to page O/13.

SCUFF PLATES FOR RIM LOCKS – SOLID BRASS



No. 5606 No. 5633
No. 5643 No. 5673

Item No.	Size	Will Fit Rim Locks
5606	4.75" x 1.875" (121 x 48mm)	5600, 5602, 5604
5633	4" x 1.875" (102 x 48mm)	5630, 5632, 5634, 5639
5643	5.75" x 1.875" (146 x 48mm)	5644
5673	3.75" x 1.875" (95 x 48mm)	5701, 5702, 5704, 5720

FEATURES: Our scuff plates are recommended for application when rim locks are used on reverse bevel doors. Prevents damage to doors and latch bolts. Provides smoother lock operation.

Rim Lock Trim

0
13
REVISION
APR 2005

SOLID BRASS FULL DUMMY TRIM FOR RIM LOCKS

Full Dummy Rim Locks are available prepared as a strike for all function rim locks. Dummy trim for rim locks consists of a hollow rim lock case (without any working mechanism), one pair of Knob No. 5030 and a half pair of No. 5002 Rose.



INSIDE

OUTSIDE

NOT REVERSIBLE—SPECIFY HAND

SOLID BRASS LOCK PLATES

Item No.				Size	Will Fit Rim Lock
Plate No.- Finish	Hand of Door	Door Application	Plate Prep		
5608.XXX	R or L	S	KC	4.75" × 3.25" (121 × 83mm)	5604
5626.XXX	R or L	S	KC	4" × 6.25" (102 × 159mm)	5634
5626.XXX	R or L	S	KC*	4" × 6.25" (102 × 159mm)	5636
5629.XXX	R or L	S	KC	4" × 6.25" (102 × 159mm)	5639
5674.XXX	R or L	S	KC	3.75" × 4.25" (95 × 108mm)	5704
5674.XXX	R or L	S	KC	3.75" × 4.25" (95 × 108mm)	5704



No. 5608 No. 5626
No. 5629 No. 5674

NOT REVERSIBLE—
SPECIFY HAND

NOTE: CYLINDER
COVER PLATE NOT
FURNISHED ON 5674

*Beveled trim for 5626 lock plate is not available.

IMPORTANT: Lock plates are only available for right and left hand cylinder operated rim locks; designed for use on the exterior side of the door.

FEATURES: Matching lock plates are designed for use on the OUTSIDE of a door. Knob trim shown is for illustration purposes only. Cylinder Cover Plate No. 6755 is secured to the plate. Note that the rose and cylinder trim normally furnished with cylinder function rim locks are not used when this plate is installed.

THICKNESS: .093" (2mm)

Example:

1 ea. 5626.003.LSKC Lock plate for a left hand (L) single (S) door for use with a 5634 (KC) lock.

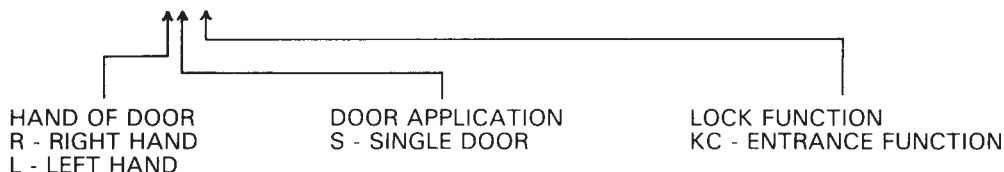

0

14

REVISION
APR 2005

Colonial Brass Rim Locks

**RESERVED FOR
FUTURE ADDITIONS**